

445 BLACKBURN ROAD

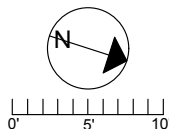

	FINISHED SQ. FT.	UNFINISHED SQ. FT.	TOTAL SQ. FT.
UPPER	2564	0	2564
LOWER	1809	0	1809
TOTAL	4373	0	4373
GARAGE	0	758	758
CARPORT	0	531	531
DECKS	0	1189	1189
PATIOS	0	716	716
G-HOUSE	0	125	125



PREPARED FOR THE EXCLUSIVE USE OF
CHRIS & DARLENE HOBBS OF
SOTHEBY'S INTERNATIONAL REALTY CANADA

MEASURED ON: 04/29/16
DRAWING FILE: 13722fm

Tafe Measure VICTORIA, B.C.
Ph. 883.8894
www.tafemeasure.com

NOTE: This floor plan is provided by Chris & Darlene Hobbs of Sotheby's International Realty Canada as a convenient reference only, and is not to be relied upon as accurate. Prospective Buyers must satisfy themselves not only of the actual measurements, but also to the status of any finished space shown on this floor plan, specifically in relation to minimum ceiling height for habitable rooms required by the BC Building Code, allowable finished floor area in relation to current zoning, and determination if space was developed with necessary municipal permits.

445 BLACKBURN ROAD

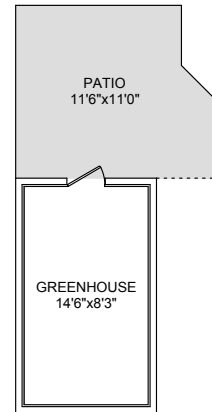
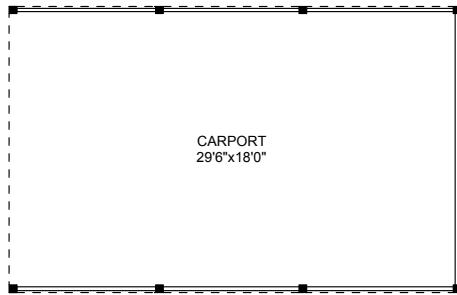
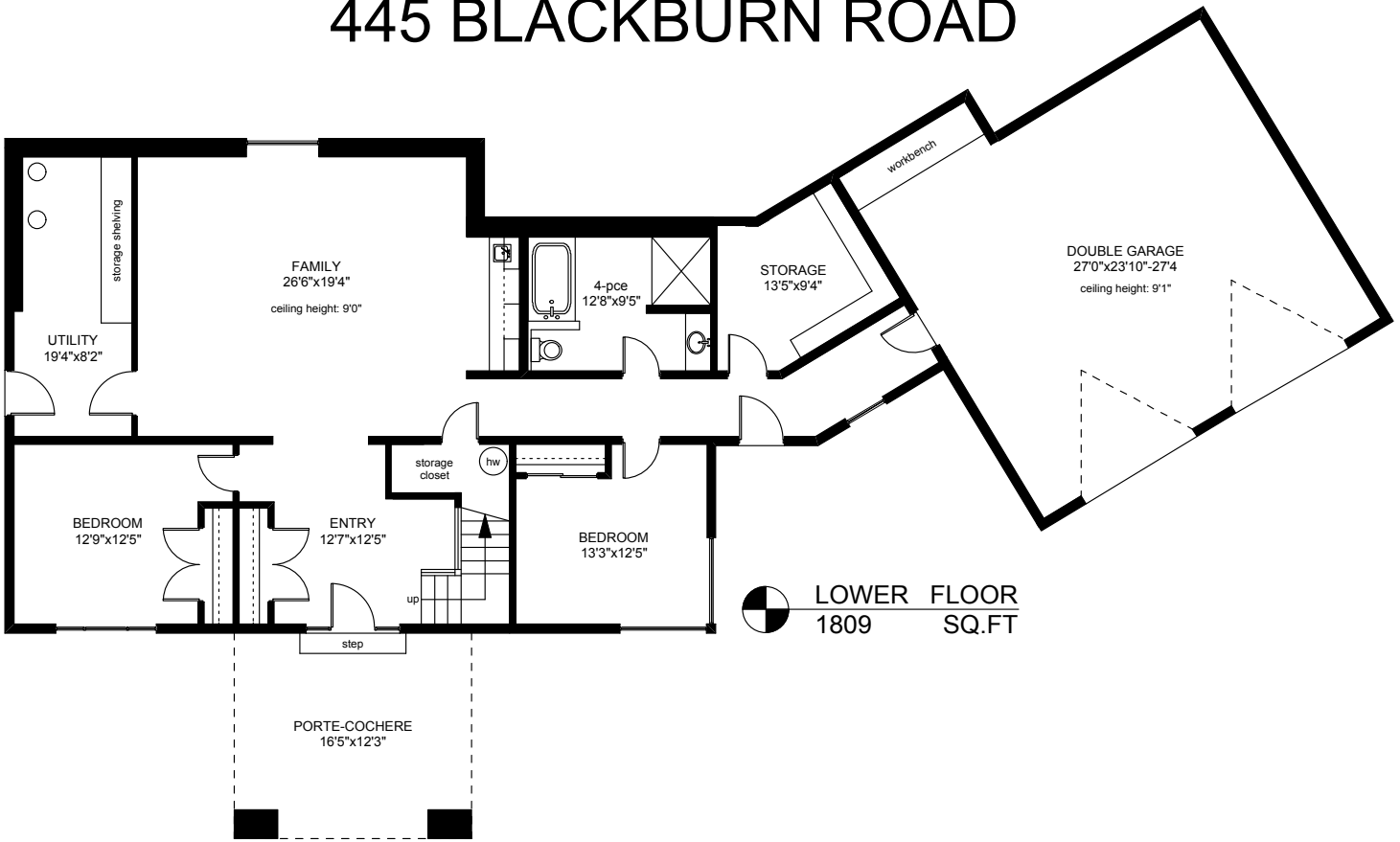

	FINISHED SQ. FT.	UNFINISHED SQ. FT.	TOTAL SQ. FT.
UPPER	2564	0	2564
LOWER	1809	0	1809
TOTAL	4373	0	4373
GARAGE	0	758	758
CARPORT	0	531	531
DECKS	0	1189	1189
PATIOS	0	716	716
G-HOUSE	0	125	125

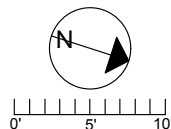

PREPARED FOR THE EXCLUSIVE USE OF
CHRIS & DARLENE HOBBS OF
SOTHEBY'S INTERNATIONAL REALTY CANADA

MEASURED ON: 04/29/16
DRAWING FILE: 13722fm

Tafe Measure VICTORIA, B.C.
Ph. 883.8894
www.tafemeasure.com

NOTE: This floor plan is provided by Chris & Darlene Hobbs of Sotheby's International Realty Canada as a convenient reference only, and is not to be relied upon as accurate. Prospective Buyers must satisfy themselves not only of the actual measurements, but also to the status of any finished space shown on this floor plan, specifically in relation to minimum ceiling height for habitable rooms required by the BC Building Code, allowable finished floor area in relation to current zoning, and determination if space was developed with necessary municipal permits.